

### ELECTRICAL SYSTEM

12 VOLT NEGATIVE EARTH  
 COLD CRANKING AMPS 166  
 FLYWHEEL TEETH 96  
 VDO OIL & TEMP SENDERS  
 ARE FITTED  
 OIL PRESSURE 500Kpa  
 WATER TEMP 120°C

### OIL SUMP PLUG

IS LOCATED FLUSH WITH  
 SUMP BOTTOM.  
 LUBE OIL MUST BE DRAINED  
 THROUGH DIPSTICK HOLE  
 ALTERNATELY DRAIN TO BE  
 EXTENDED BY PUMP  
 PACKAGER

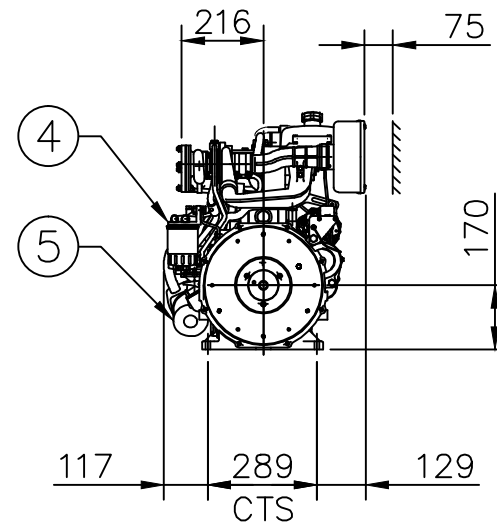
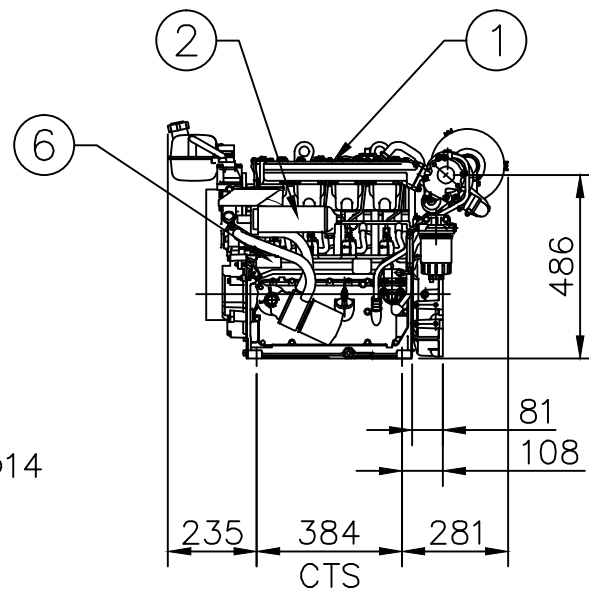
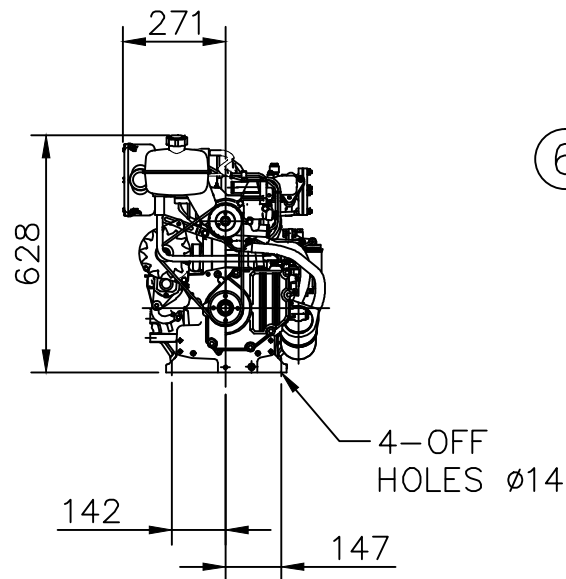
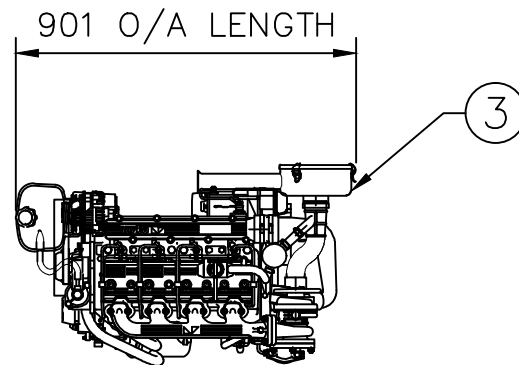
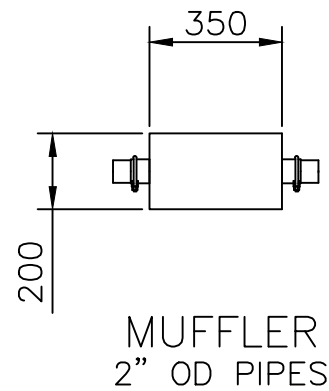
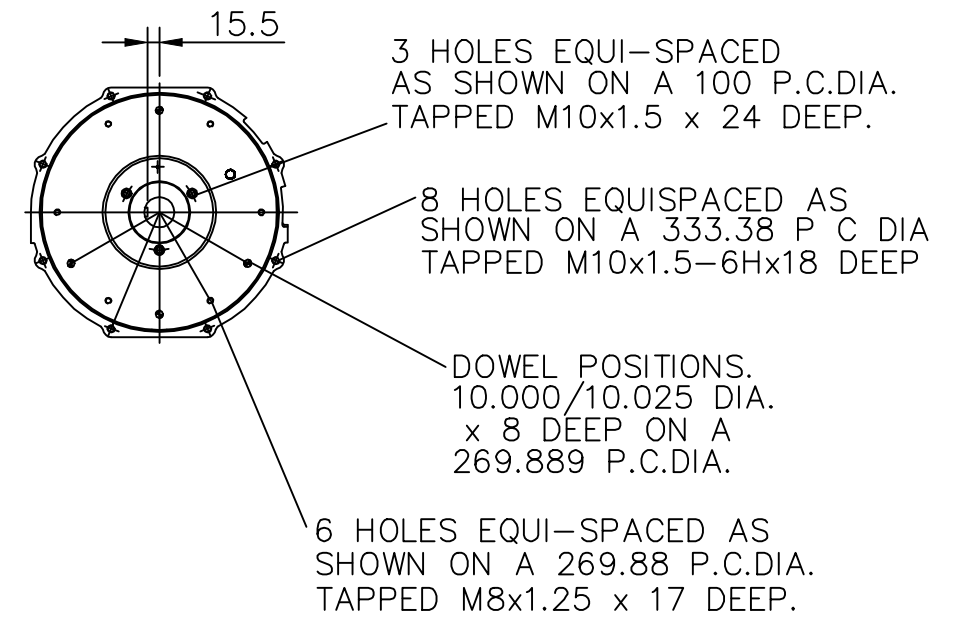
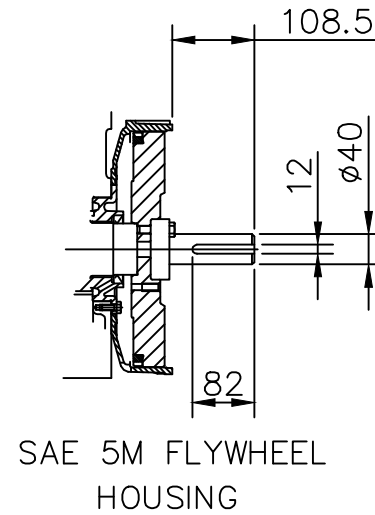

### COOLING WATER FLOW RATE

MINIMUM FLOW RATE IS  
 0.5 LITRES PER SECOND @ 20°. HIGHER FLOW RATES ARE REQUIRED AT HIGHER TEMPERATURES. FAILURE TO PROVIDE THIS FLOW RATE WILL CAUSE PERMANENT ENGINE FAILURE WITHIN MINUTES OF RUNNING THE DIESEL ENGINE.

WEIGHT = 200 Kg. APPROX

ITEM	QTY	DESCRIPTION	W&C REF. No.	Wt. Kg.
6	1	SOLENOID	LISTER	-
5	1	OIL FILTER	LISTER	-
4	1	FUEL FILTER	LISTER	-
3	1	AIR FILTER	LISTER	-
2	1	HEAT EXCHANGER	LISTER	-
1	1	LPWT4-46 DIESEL ENGINE	LISTER	-

REV.	DESCRIPTION	DRN	DATE	CHK.	DATE.
-	-	-	-	-	-
-	-	-	-	-	-
-	-	-	-	-	-
B	ISSUED FOR MANUFACTURE	R.M.	20.04.11	P.N.L.	20.04.11
A	ISSUED FOR APPROVAL	R.M.	20.04.11	P.N.L.	20.04.11

TO BE MODIFIED ON CAD ONLY DRN. R.M. 20.04.11  
 DRAWN SCALE : 1:1 CHK. P.N.L. 20.04.11  
 PLOT SCALE : 1:20 @ A3 ENG. P.N.L. 20.04.11  
**WELLING & CROSSLEY PTY LTD**  
 59 EXPORT DRIVE BROOKLYN VIC. 3012  
 1042 CANLEY VALE RD, WETHERILL PK NSW 2164  
 UNIT 5/235 CAMBOON RD MALAGA WA 6090  
 UNIT 11/1909 IPSWICH ROCKLEA QLD 4106  
 EMAIL: wellcross@wellcross.com.au

THIS DRAWING AND DESIGN REMAIN THE PROPERTY OF WELLING & CROSSLEY PTY. LTD. A.B.N. 61 005 690 273. THIS DRAWING AND DESIGN CAN NOT BE COPIED OR ALTERED IN ANY WAY WITHOUT PRIOR WRITTEN APPROVAL FROM WELLING & CROSSLEY PTY. LTD. THIS DRAWING AND ALL COPIES, HARD & SOFT MUST BE RETURNED TO WELLING & CROSSLEY PTY. LTD. UPON REQUEST FROM WELLING & CROSSLEY PTY. LTD.

TITLE : FIRE PUMP DIESEL ENGINE  
 LPWT4-46 LISTER HEAT EXCHANGER  
 GENERAL ARRANGEMENT  
 DRG No: 20-LPWT4-46-0 A3 REV B